



**USER MANUAL**

[www.vivos.com.my](http://www.vivos.com.my)

# VIVOS LCD User Programming Guide (VG1-16z-V1)



Enter Programming: [Mode + 4 x Digits Code + Enter]  
(Default Code: 1234)

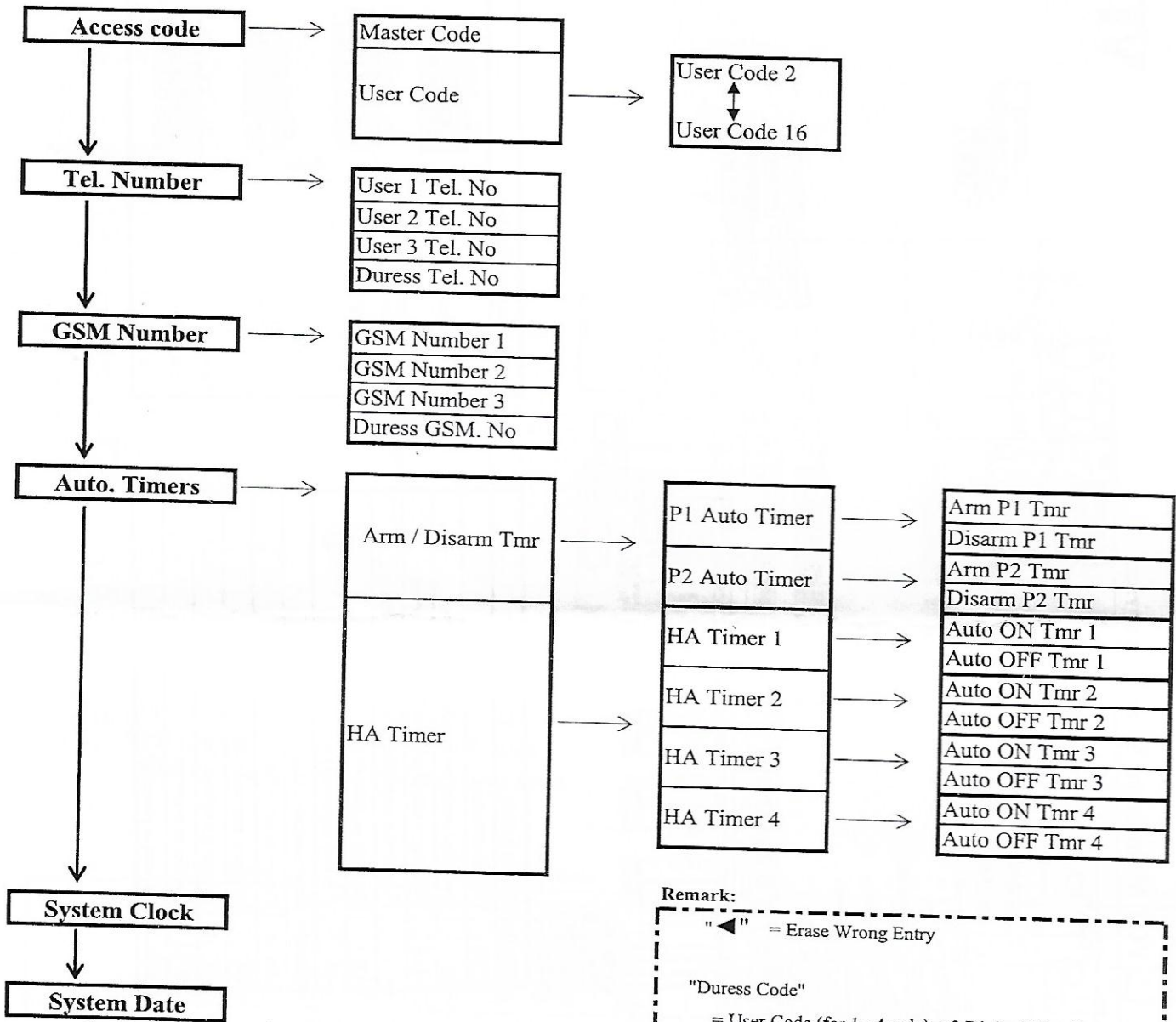

**Remark:**

"◀" = Erase Wrong Entry

"Duress Code"  
= User Code (for 1~ 4 only) + 2 Digits (00) + Enter

Exit Programming: [Mode + Enter]

# VG1 Mainboard Wiring Diagram

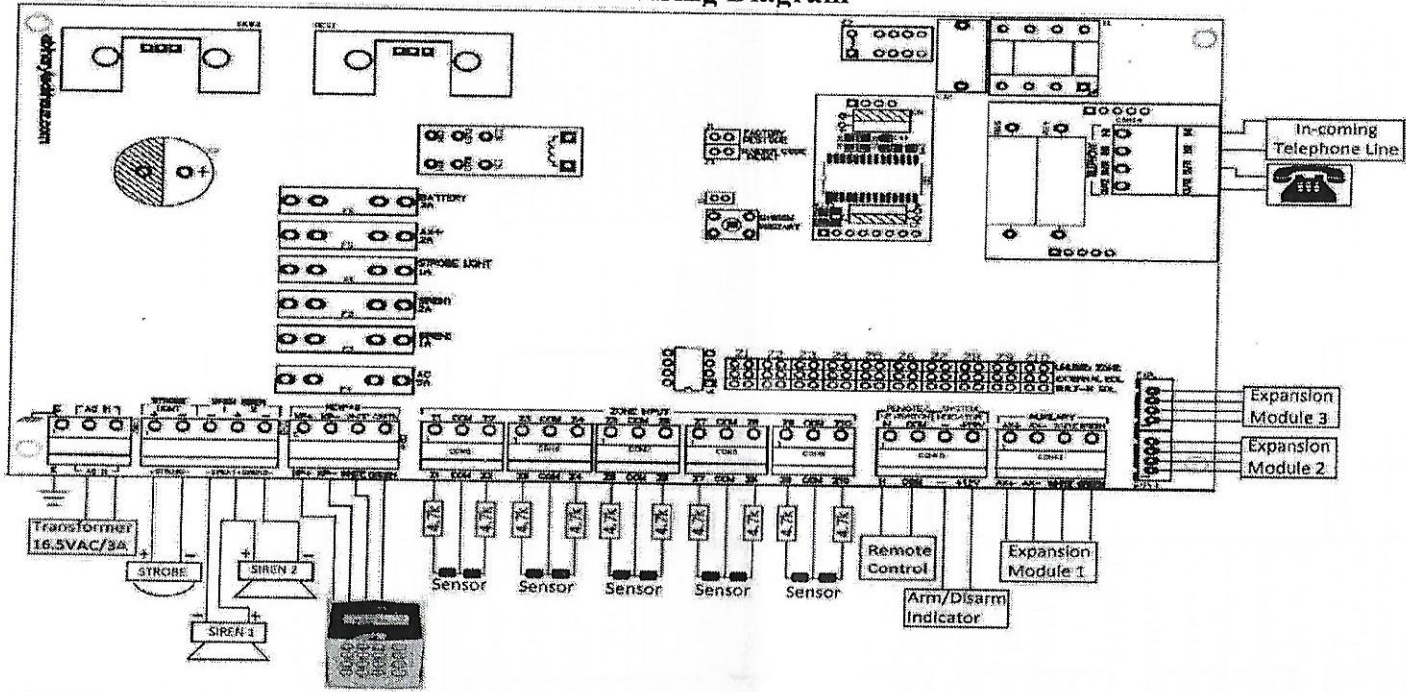

Symbol	Description
E	Earth
Ac In	16.5VAC Input
Z1	Zone 1
Z2	Zone 2
Z3	Zone 3
Z4	Zone 4
Z5	Zone 5
Z6	Zone 6
Z7	Zone 7
Z8	Zone 8
Z9	Zone 9
Z10	Zone 10

Symbol	Description
COM	Negative(Ground)
IN	Input for remote/key switch
+12V	Positive(+) output for Arm/Disarm indication
-	Negative(-) output for Arm/Disarm indication
AX +	Auxiliary positive(+) output
AX -	Auxiliary negative(-) output
WHITE	Communication Data(+)
GREEN	Communication Data(-)
IN1	Incoming telephone line
IN2	Incoming telephone line
OUT1	Connect to phone set
OUT2	Connect to phone set

Zone Jumper Setting	
Unused Zone	=
External EOL	=
Built-in EOL	=
Remark:	
No Jumper	=
Zone will not work	

# VIVOS LCD Installer Programming Manual (VG1-16z-VI)



Enter Installer Programming: [Mode + 6 x Digits Code + Enter]



Exit Installer Programming: [Mode + Enter]

**NOTE:** Keypad ID Drawing

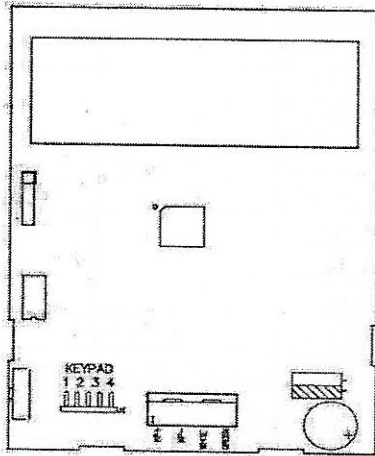

**Keypad Drawing**

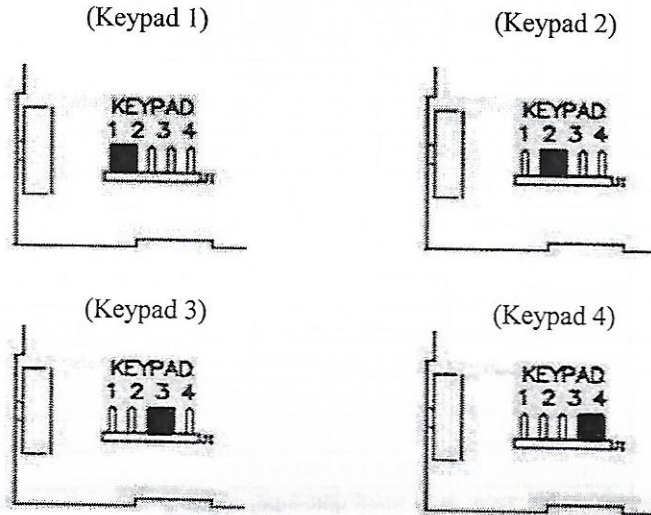

**Keypad ID**

- 1) (S1) Tact Switch = System Restart (Press and Hold 3 seconds)
- 2) J1 (Jumper 1) = Factory Restore
- 3) J2 (Jumper 2) = Master Code Reset

Main	Sub-menu	Descriptions	Default Setting															
			1	2	3	4	5	6	7	8	9	10	11	12	13	14	15	16
Zone Setup ↓	Fire Zone	Assigned when zone number displayed "YES"	ALL NO															
	24 Hour Zone	Assigned when zone number displayed "YES"	ALL NO															
	Instant Zone	Assigned when zone number displayed "YES"		Y	Y	Y	Y	Y	Y	Y	Y	Y	Y	Y	Y	Y	Y	Y
	Delay Zone	Assigned when zone number displayed "YES"	Y															
	Internal Zone	Assigned when zone number displayed "YES"	ALL NO															
	Stay Zone	Assigned when zone number displayed "YES"	ALL NO															
	Silent Zone	Assigned when zone number displayed "YES"	ALL NO															
	Light Zone	Assigned when zone number displayed "YES"	ALL NO															

**Remark:** Y = YES                      √ = ON  
 N = NO                                X = OFF

Press keypad number [0] to change √ or X  
 Zone 1 = Press 01, Zone = Press 02 ~ Zone 16 = Press 16

Main	Sub-menu	Descriptions	Default Setting
System Setup ↓	Partition	Enable or Disable for Partition	X
	Voice-English	√ = English / X = Mandarin	√
	StartUp Delay	Delay 30 seconds when System Start Up	X
	Tel 1 for P1	Telephone number 1 for Partition 1	√
	Tel 2 for P1	Telephone number 2 for Partition 1	√
	Tel 3 for P1	Telephone number 3 for Partition 1	√
	Tel 1 for P2	Telephone number 1 for Partition 2	√
	Tel 2 for P2	Telephone number 2 for Partition 2	√
	Tel 3 for P2	Telephone number 3 for Partition 2	√
	Zone B/Light	Keypad Back Light 10 seconds for zone open or closed	√
	Siren 1 Pulse	Siren 1 Pulse Output	X
	Stay Arm-Entry Delay	Entry Delay for Stay Arm	X
	Stay Arm-Exit Delay	Exit Delay for Stay Arm	X
	Keyswitch – P1	Keyswitch assigned to Partition 1	√
	Keyswitch – P2	Keyswitch assigned to Partition 2	√
	Keyswitch – Momentary	Keyswitch Momentary = √ / Latch = X	√
	Keyswitch – NC	Normally Close (NC) = √ / Normal Open (NO) = X	√
	Siren 1 – P1	Siren 1 for Partition 1	√
	Siren 1 – P2	Siren 1 for Partition 2	√
	Siren 2 – P1	Siren 2 for Partition 1	√
	Siren 2 – P2	Siren 2 for Partition 2	√
	KS –Siren Toot	√ = Siren indication / X = Strobe Light indication	√
	Check Battery	Check Battery Low status (Hourly)	√
Check Siren 2	Check Siren 2 status	X	
Check Strobe	Check Strobe Light status	X	
Check Tel-Line	Check Telephone Line Status	X	

Press keypad number [0] to change √ or X

Main	Sub-menu	Sub-menu	Descriptions	Default Setting
Delay / Siren Timer ↓	P1 Delay Timer	P1 Entry Delay	5 to 240 seconds	30
		P1 Exit Delay	5 to 240 seconds	60
	P2 Delay Timer	P2 Entry Delay	5 to 240 seconds	30
		P2 Exit Delay	5 to 240 seconds	60
	Siren Timer	P1 Siren Timer	1 to 240 minutes	5
		P2 Siren Timer	1 to 240 minutes	5

**Remark:** Y = YES  
N = NO

√ = ON  
X = OFF

Press keypad number [0] to change √ or X  
Zone 1 = Press 01, Zone = Press 02 ~ Zone 16 = Press 16

Main	Sub-menu	Sub-menu	Descriptions	Default Setting																
				1	2	3	4	5	6	7	8	9	10	11	12	13	14	15	16	
User Option ↓	User Control	Arming User	Choose which user to Arm	ALL User Arm																
		Disarming User	Choose which user to Disarm	ALL User Disarm																
	Partition User	P1 User	Choose which user for Partition 1	ALL P1 User																
		P2 User	Choose which user for Partition 2	Y																
	Zone Partition	P1 Zones	Choose which zone for Partition 1	ALL P1 Zone																
		P2 Zones	Choose which zone for Partition 2	NO Partition Zone																

Main	Sub-menu	Sub-menu	Descriptions	Default Setting															
				1	2	3	4	5	6	7	8	9	10	11	12	13	14	15	16
Home Tel Setup ↓	Reporting	Personal Call	Call to User Tel No 1 to 3	√															
		CMS Reporting	Report to CMS Center	X															
		Fax Override	To bypass Fax Machine	X															
		Full Reporting	Call to all User Tel Number	X															
		Battery Low	Call to User when Battery Low	X															
		AC Fail	Call to User when AC fail	X															
		Siren Fail	Call to User when Siren Fail	X															
		S1 ON-Tel Fail	Siren 1 on when Tel-line Fail	X															
		S2 ON-Tel Fail	Siren 2 on when Tel-line Fail	X															
	Number of Rings	Number of Rings to call in system (1 to 240 times)		010															
	Dialing Attempt	Number of Times to call out (1 to 240 times)		003															
	Dialing Time	Auto cut off time for each CMS or Personal Number called (20 to 60 seconds)		040															

**Noted:** ▶ = Pause 5 seconds, Panic = \* key (special input for tel number)

Main	Sub-menu	Sub-menu	Descriptions	Default Setting															
				1	2	3	4	5	6	7	8	9	10	11	12	13	14	15	16
CMS Setting ↓	CMS 1	CMS Account 1	4 digits number	0000															
		CMS Telephone 1	Max to 14 digits Tel Number	Disable															
	CMS 2	CMS Account 2	4 digits number	0000															
		CMS Telephone 2	Max to 14 digits Tel Number	Disable															
	Reporting	AC Fail	Report to CMS when AC fail	√															
		Siren 1 Fail	Report to CMS when siren 1 fail	√															
		Siren 2 Fail	Report to CMS when siren 2 fail	X															
		Battery Low	Report to CMS when battery low	√															
		Arm/Disarm	Report to CMS when arm / disarm	√															
		Duress	Report to CMS when duress	√															
		Panic	Report to CMS when panic	√															
		Bypass/Restore	Report to CMS when bypass	√															
		System Reset	Report to CMS when system reset	√															
	CMS Zone	CMS zone is assigned when zone number displayed Yes		ALL CMS Zone															
	CMS Test	Number of hours to send test report to CMS Center (01 to 24 Hours)		24															
	CMS Test Time	Set Clock time to send test report to CMS Center (00:00 to 23:59)		0000															

**Remark:** Y = YES  
N = NO

√ = ON  
X = OFF

Press keypad number [0] to change √ or X  
Zone 1 = Press 01, Zone = Press 02 ~ Zone 16 = Press 16

Main	Sub-menu	Sub-menu	Descriptions	Default Setting															
				1	2	3	4	5	6	7	8	9	10	11	12	13	14	15	16
Home Automation Setting ↓	HA Point Timer	HA Pts on Tmr 1	HA Points grouping in Timer 1	ALL HA OFF															
		HA Pts on Tmr 2	HA Points grouping in Timer 2	ALL HA OFF															
		HA Pts on Tmr 3	HA Points grouping in Timer 3	ALL HA OFF															
		HA Pts on Tmr 4	HA Points grouping in Timer 4	ALL HA OFF															
	Vacation HA	HA point turn on from 12am ~ 8am during Vacation arm Random HA point turn on from 6pm ~ 12am		ALL HA OFF															
	Night Hour	Start hour (first 2 digits), End night hour (last 2 digits) from 00 to 23 in 24 hour format e.g. 19 = 7pm, 07 = 7am		99-99 (Disable)															
	Zone Trigger X	Zone 01 Trigger ↑ ↓ Zone 16 Trigger	HA point turn on when zone trigger	ALL Z1 ~ Z16 - HA OFF															
	Trigger Timer	HA 01 OFF Timer ↑ ↓ HA 16 OFF Timer	Duration to auto off HA Point (From 1 to 240 minutes)	003															
Auto OFF HA	Zone number displayed "YES" follow "Trigger Timer"		ALL HA ON																
HA Latch / Momentary	HA 01 Latch ↑ ↓ HA 16 Latch	Output selection for HA points (√ = latch / x = Momentary)	ALL √																

Main	Sub-menu	Descriptions	Default Setting															
			1	2	3	4	5	6	7	8	9	10	11	12	13	14	15	16
Sensitivity ↓	Zone Response	YES = Fast Response, NO = Slow Response	ALL YES															
	Fast Response	From 1 to 240 (*10ms)	003															
	Slow Response	From 1 to 240 (*10ms)	010															
	Smart Zone	Assigned for trip count group when zone number displayed "YES"	ALL NO															
	Zone Counter	Zone trigger count from 1 to 240 times	003															
	Zone Reset Timer	Zone reset timer from 1 to 240 minutes	010															

Main	Sub-menu	Descriptions	Default Setting															
			(Please refer to Manufacture)															
Installer Option ↓	Installer Code	Change Installer Code (6 digits code)	(Please refer to Manufacture)															
	Master Code	Default Code = 1234	Enter = YES Clear = NO															
	Reset		Enter = YES Clear = NO															
	Factory Reset	All setting restore to Factory Default	Enter = YES Clear = NO															
	Firmware Version	Display Mainboard and Keypad firmware version	-----															
System Restart	Restart Mainboard to activate module ID	Enter = YES Clear = NO																

Main	Sub-menu	Descriptions	Default Setting															
Keylock ↓	Keylock Count	Number of count to lock keypad when invalid code entry [from 1 to 240 times]	010															
	Keylock Timer	Keypad lock reset timer [from 1 to 240 minutes]	003															
	(Reserved)																	

**Remark:** Y = YES  
N = NO

√ = ON  
X = OFF

Press keypad number [0] to change √ or X  
Zone 1 = Press 01, Zone = Press 02 ~ Zone 16 = Press 16

Main	Sub-menu	Descriptions	Default Setting
GSM Setup	GSM Reporting	Dial - Fix Line	√
		Dial - GSM Line	X
		SMS GSM No. 1	X
		SMS GSM No. 2	X
		SMS GSM No. 3	X
		Arm / Disarm Report	X
		Trouble Report	X
		Door Report	X
		Dial - Signal Low	X
			X
	Zone Open SMS	Zone 1 Report	ALL Zone Report - X
		Zone 2 Report	
		Zone 3 Report	
		Zone 4 Report	
		↕	
		Zone 13 Report	
		Zone 14 Report	
Zone 15 Report			
Zone 16 Report			

**Remark:** Y = YES  
N = NO

√ = ON  
X = OFF

Press keypad number [0] to change √ or X  
Zone 1 = Press 01, Zone = Press 02 ~ Zone 16 = Press 16





Example of SMS received.

Example 1:

ARM-UX;  
(END)

System Arm by User X, where X is the user number. User 2 indicates as "U2".  
For Master Code, it will not display any user information, i.e, Arm/ Disarm only.

Example 2:

ALARM: Z2,Z3  
(END)

Zone 2 and 3 violated.

Example 3:

AC FAIL;  
(END)

AC loss.

Example 4:

DOOR OPEN; 3  
(END)

Zone 3 Open.

## Telephony Voice Control

<i>Event</i>	<i>Voice</i>
Call in & System Call Out	Please enter code (请输入密码)
Password Enter Correct	Thank you. Enter Command or for menu, press * (谢谢,输入指令或目录, 请按星字键)
Key in Wrong Password / Command	Invalid Entry (输入错误)
Press * Key for the Voice Menu	<p>To Arm or Disarm, press 1.            To Switch OFF or ON siren, press 2.            For Bypass Zone, press 3.            For Automation control, press 4.            For System Status, press 0.            To end the call anytime, press 9 and then #</p> <p>系统启动或关闭, 请按一。            开关警笛, 请按二。            绕行防盗地区, 请按三。            家居遥控, 请按四。            查询系统报告, 请按零。            停止通话, 请按九, 然后井字键</p>
Arm System	System Arm (系统启动)
Disarm System	System Disarm (系统关闭)
Activate Siren	Siren ON (警笛开)
Deactive Siren	Siren OFF (警笛关)
Zone Status	Zone 1 to Zone 16: (防盗地区) • Open (打开) • Bypass (绕行) • Restore (恢复) • Alarm (警号)
After all status reported	Reporting End (报告完毕)
Panic button activated	Panic (惊慌)
End or Finish the call	Good Bye (再见)

## Operation Summary

System Disarm	[4-digits Password] + [Enter]
Away Arm	Press hold keypad number [1] for 1 seconds / [4-digits Password] + [Enter]
Stay Arm	Press hold keypad number [2] for 1 seconds
Vacation Arm	Press hold keypad number [3] for 1 seconds
Force Arm	Press hold keypad number [4] for 1 seconds
Bypass Zone	Press hold keypad number [5] for 1 seconds + [zone numbers 01 ~ 16] + [Enter]
Automation Point On / Off	Press hold keypad number [6] for 1 seconds + [Automation Points 01 ~ 16] + [Enter]
Service	Press hold keypad number [7] for 1 seconds
Chime Zone	Press hold keypad number [8] for 1 seconds + [zone numbers 01 to 16] + [Enter]
System Test*	Press hold keypad number [9] for 1 seconds
Event Memory**	Press hold keypad number [0] for 1 seconds
Activate Panic Alarm	Press hold keypad number [Panic] for 1 seconds
Keypad Buzzer On / Off	On = Slide Upward, Off = Slide Downward

### **Remark:**

#### **P1 & P2 LED Indicator**

Yellow Slow Blink = Zone Bypassed

Red Slow Blink = Arm with Zone Bypassed

#### **For Arm / Disarm Partitioning**

Press 1 = P1 (Partition 1)

Press 2 = P2 (Partition 2)

Press 0 = All Partition

\***System Test List** = Zone test, Battery test, Siren 1 & 2 test, Strobe Light test, CMS test

\*\***Event Memory** = 50 Event Logs

For more details user manual info, please download from [www.vivos.com.my](http://www.vivos.com.my)



# 电话遥控操作目录 (VGI-16z-V1)



系统呼出  
接听电话



按密码  
4位数密码+#号

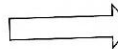

呼入到系统  
输入电话号码



4位数密码+#号

## 按号码

- [1] 系统启动/关闭
- [2] 警笛开/关
- [3] 绕行防盗地区/恢复 01至16地区  
00=全部地区
- [4] 家居遥控开/关 01至16家居遥控  
00=全部家居遥控
- [0] 查询系统报告
  - 系统启动/关闭
  - 警笛开/关
  - 系统问题报告
  - 威胁用户 1/2/3
  - 防盗地区绕行/开着
  - 家居遥控开/关
  - 惊慌!!!
- [9+#] 停止通话
- [\*] 操作指导目录

### 注意:

当没有任何按键入在60秒之内,电话会自动停止通话.

当输入超过5次的错误密码,电话会自动停止通话.

只有用户1~4才可以通过电话遥控来操作系统.